

TOWNSHIP OF NUTLEY
TOWNSHIP OF LYNDHURST

COUNTY OF ESSEX
COUNTY OF BERGEN

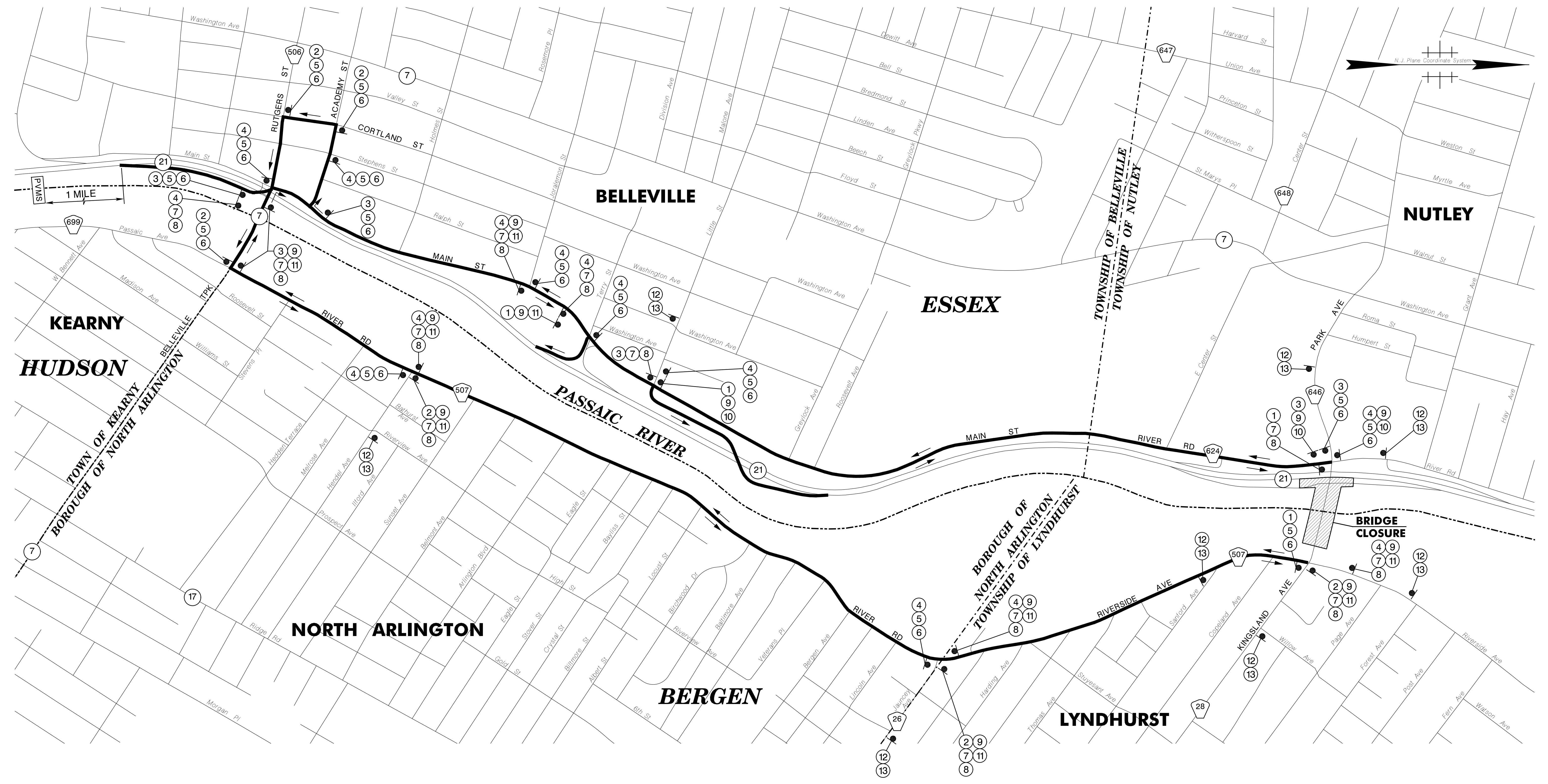
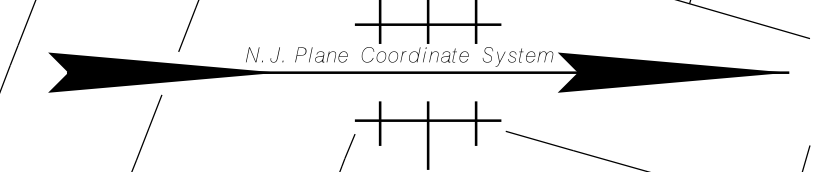

**SOUTHERN DETOUR PLAN FOR KINGSLAND AVENUE BRIDGE
AND NJ ROUTE 21 NORTHBOUND RAMPS**

NOT TO SCALE

BERGEN COUNTY
DEPARTMENT OF PLANNING AND ENGINEERING

**TRAFFIC CONTROL AND
STAGING PLANS**

REPLACEMENT OF THE KINGSLAND AVENUE
(AVONDALE & DE JESSA MEMORIAL) BRIDGE
OVER THE PASSAIC RIVER

TOWNSHIP OF NUTLEY
TOWNSHIP OF LYNDHURST

ESSEX COUNTY
BERGEN COUNTY
NEW JERSEY

In Charge of _____
Designed by _____
Design Checked by _____
Detailed by _____
Detail Checked by _____

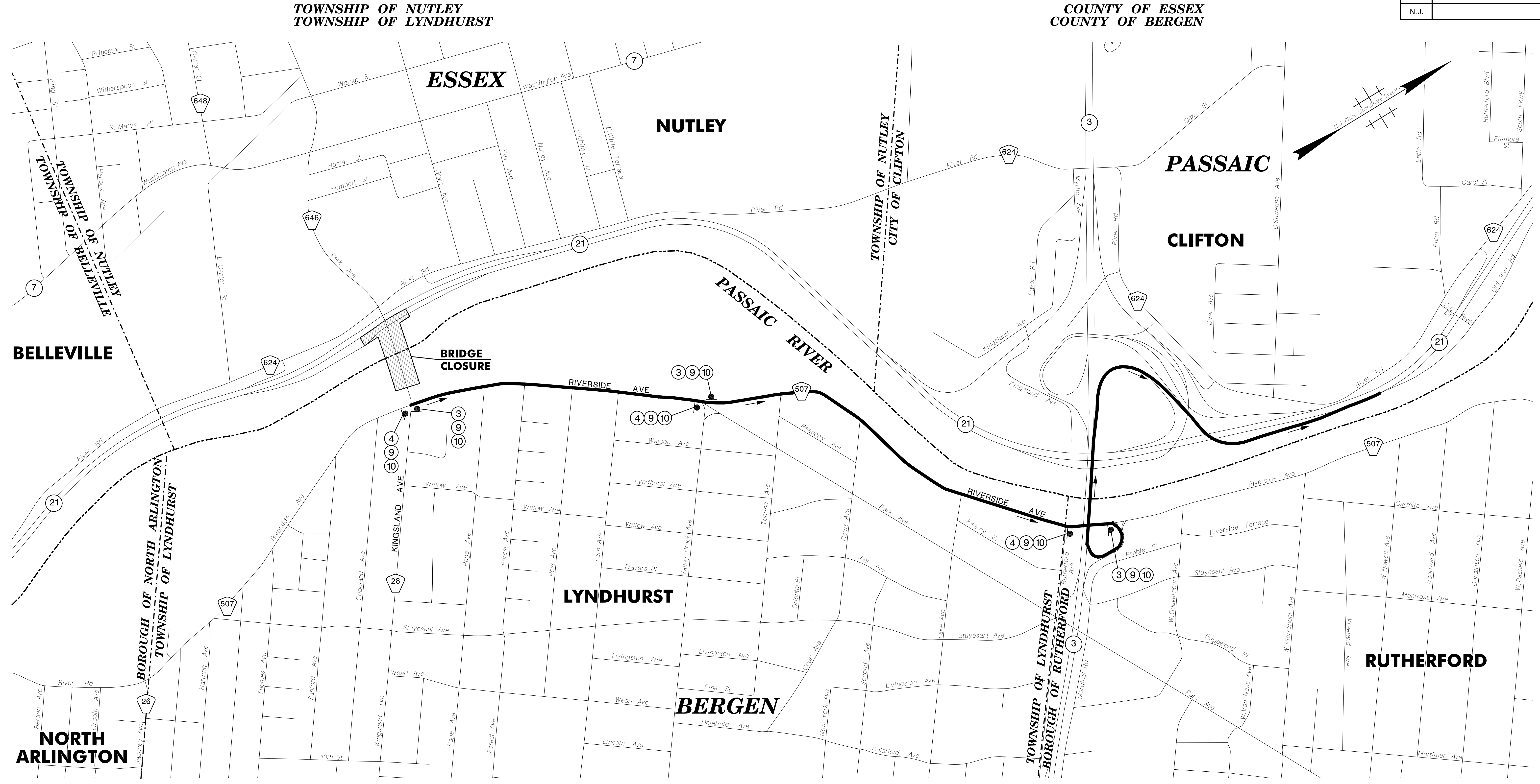

**NORTHERN DETOUR PLAN FOR KINGSLAND AVENUE BRIDGE
AND NJ ROUTE 21 NORTHBOUND RAMPS**

NOT TO SCALE

BERGEN COUNTY
DEPARTMENT OF PLANNING AND ENGINEERING
**TRAFFIC CONTROL AND
STAGING PLANS**
REPLACEMENT OF THE KINGSLAND AVENUE
(AVONDALE & DE JESSA MEMORIAL) BRIDGE
OVER THE PASSAIC RIVER

TOWNSHIP OF NUTLEY
TOWNSHIP OF LYNDHURST
ESSEX COUNTY
BERGEN COUNTY
NEW JERSEY

In Charge of _____
Designed by _____
Design Checked by _____
Detailed by _____
Detail Checked by _____

H&H
Hamilton, NJ